

Family Dollar Anchored Center

Major Retail Corridor | High Traffic Counts

810 Dix-Toledo, Lincoln Park, Michigan 48146



This is an extraordinary opportunity to lease in a newly constructed retail building with Family Dollar as the anchor tenant at a major intersection in Lincoln Park, Michigan. The building will be located at the SWC of Dix-Toledo and Outer Drive (two extremely high traffic arteries in a major retail corridor). The project consists of a single-story, brick building containing approximately 14,000 square feet.

- In-line spaces from 1,055 square feet to 2,100 square feet.
- Approved to accommodate a 2,000 square foot drive-thru tenant ideal for food fast or coffee tenant.
- Population (3 Miles): 112,558
- Households (3 Miles): 45,115
- Median Household Income: \$44,359
- Traffic Counts: 12,239 ADT
- Located within minutes of Sears-anchored shopping center, fast food chains, banks and other national retailers

For Additional Information please contact:

734.454.1855



**PARAMOUNT
REAL
ESTATE
SERVICES**



Family Dollar Anchored Center

Major Retail Corridor | High Traffic Counts

810 Dix-Toledo, Lincoln Park, Michigan 48146

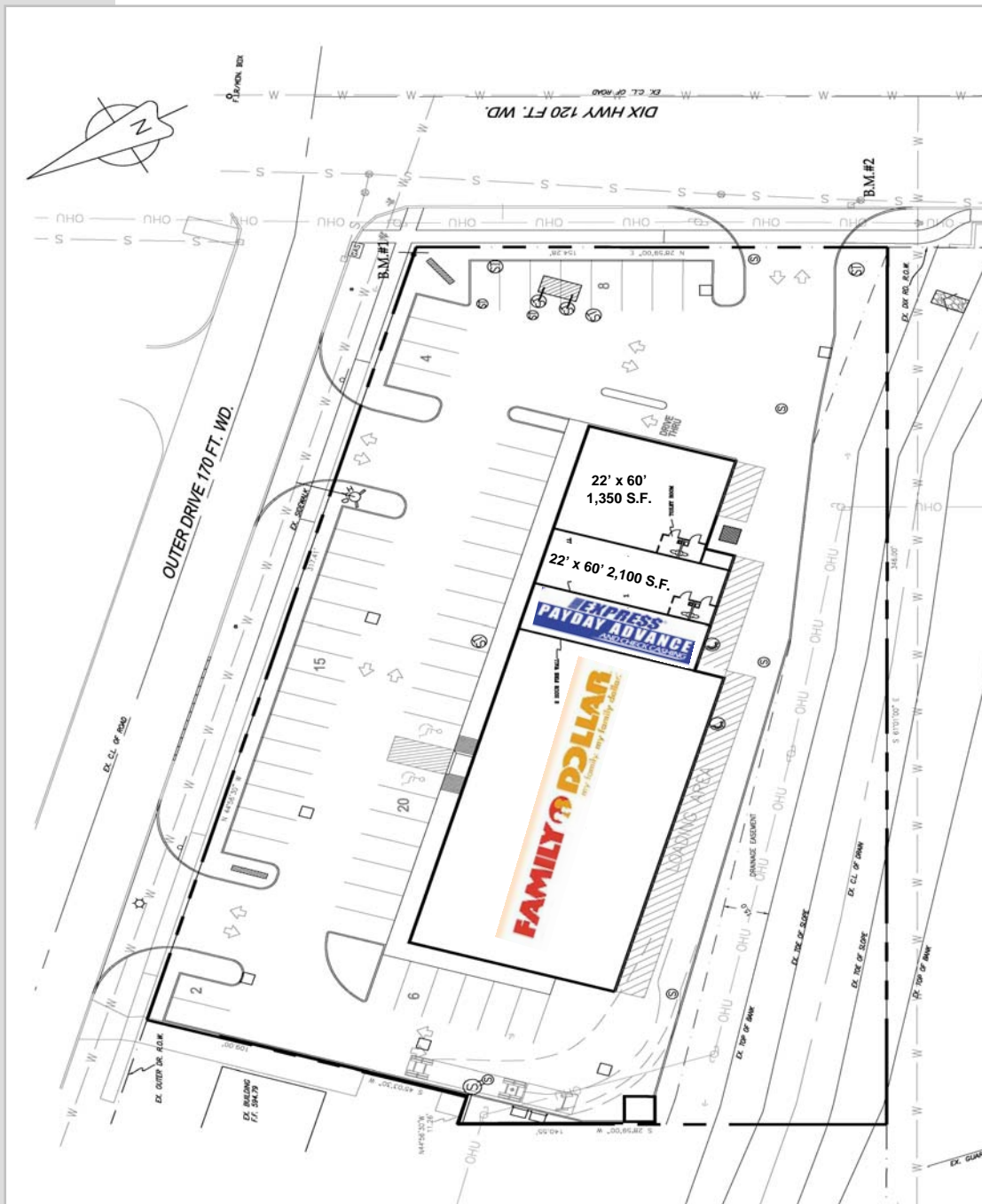

For Additional Information, contact:

734.454.1855



**PARAMOUNT
REAL
ESTATE
SERVICES**