

Westview Retail Plaza

Strong National Co-Tenants | Major Retail Corridor

6054 Wayne Road, Westland, Michigan 48185



Join These Tenants:



This is an extraordinary opportunity to lease in a newly renovated retail building (2001-2002) located in Westland, Michigan that is anchored by Family Dollar. The building is located on Wayne Road in close proximity to Westland Mall. Wayne Road is an extremely high traffic artery in a major retail corridor. Opportunity to lease 1,900 square feet available. Existing tenants include Family Dollar, Murray's, Secretary of State, AGU Insurance, Cash Connection, President Tuxedo and H&R Block.

- 1,900 Square Feet Available
- \$12.00 per Square Foot plus NNN
- Population (3 Miles): 115,676
- Households (3 Miles): 48,390
- Median Household Income (3 Miles): \$51,350
- Traffic Counts: 16,793 ADT
- Immediate Availability
- Strong National Co-Tenants



CASH CONNECTION

For Additional Information please contact:

734.454.1855

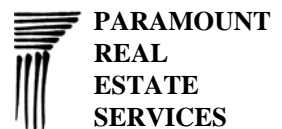

Westview Retail Plaza

Strong National Co-Tenants | Major Retail Corridor

6054 Wayne Road, Westland, Michigan 48185

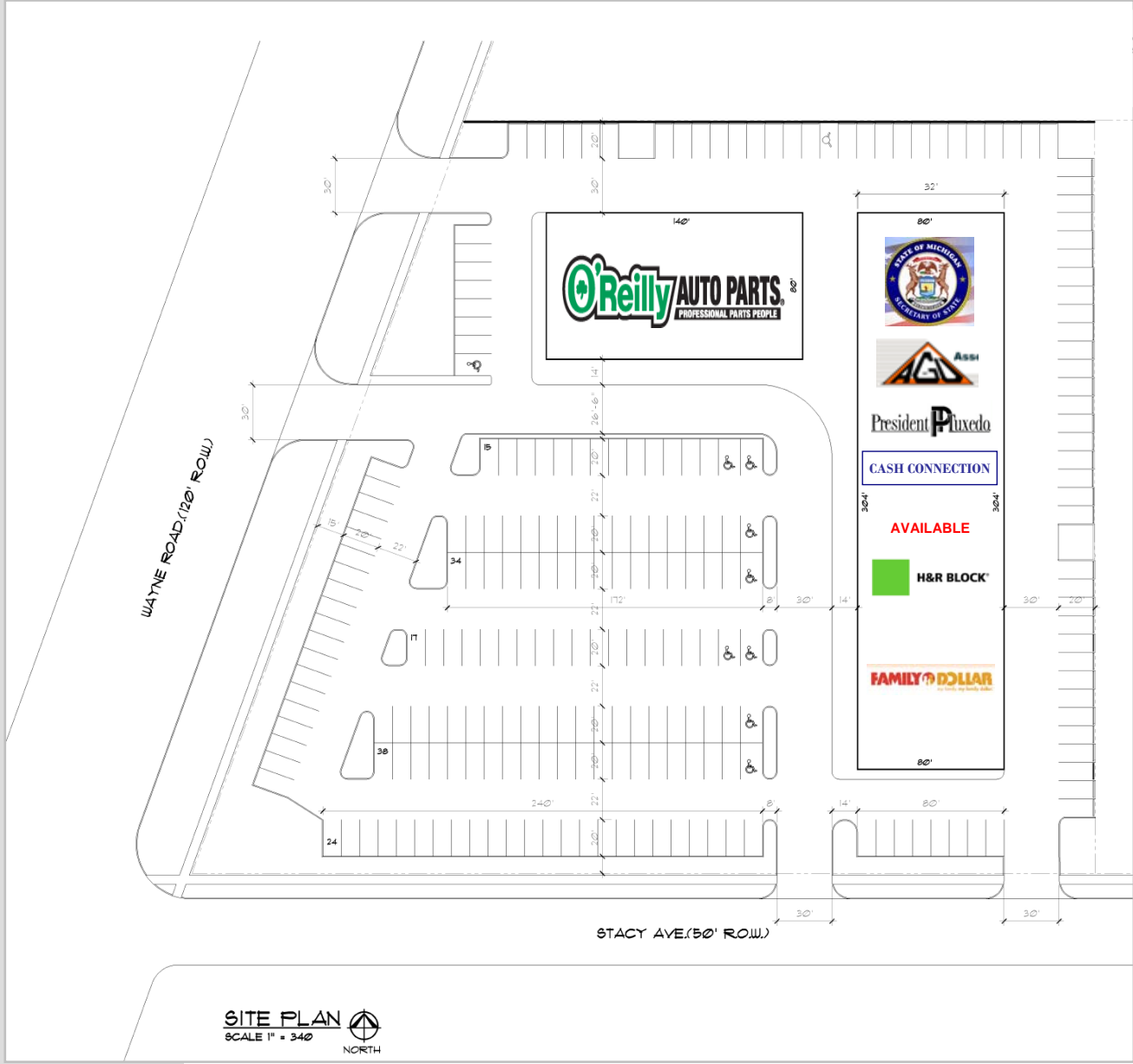

SITE PLAN
SCALE 1" = 340'
NORTH

For Additional Information, contact:
734.454.1855

