

Prime Retail Development

Newly Renovated | Major Retail Corridor | High Traffic Counts

Canton Landings | 44924 Ford Road, Canton, Michigan 48187



This is an extraordinary opportunity to lease in a newly renovated retail center located on Ford Road in Canton, Michigan. The subject property is beautifully landscaped and well maintained to create a “campus like” setting for Tenants. Canton Landings is served by many nearby restaurants and services and offers Tenants easy access to both I-275 and M-14. Additionally, the property is strategically located in the heart of the Canton office and retail corridor between Canton Center and Sheldon Roads.

- 4,651 and 1,435 Square Feet Available
- \$16.00 Plus NNN Charges
- Traffic Counts: 30,600 AADT
- Population (3 Miles): 85,082
- Households (3 Miles): 30,463
- Median Household Income: \$85,931
- Located in the heart of the Canton restaurant and retail corridor

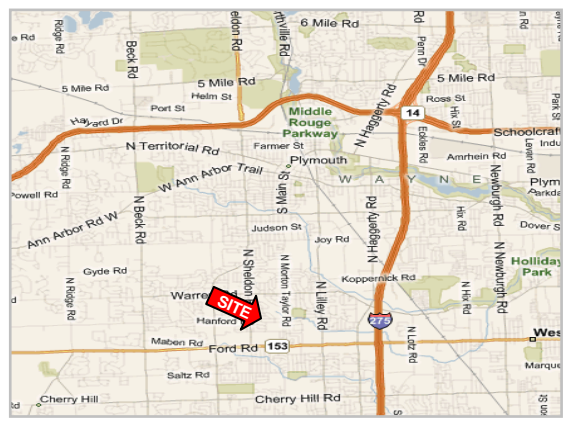

For Additional Information please contact:
734.454.1855



Prime Retail Development

Newly Renovated | Major Retail Corridor | High Traffic Counts

Canton Landings | 44924 Ford Road, Canton, Michigan 48187

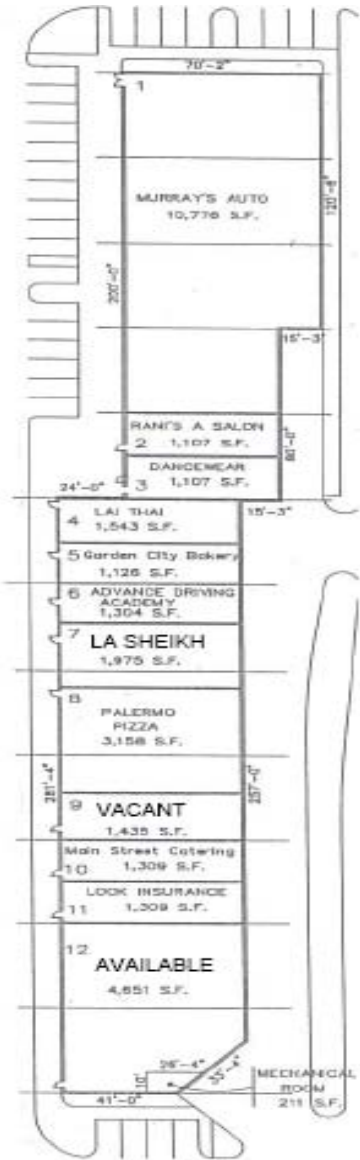

For Additional Information, contact:

734.454.1855



**PARAMOUNT
REAL
ESTATE
SERVICES**